

thaMograph[®]

User's Guide

To draw a circle

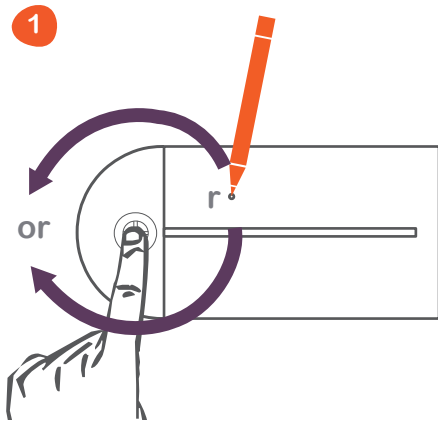

2 Result:

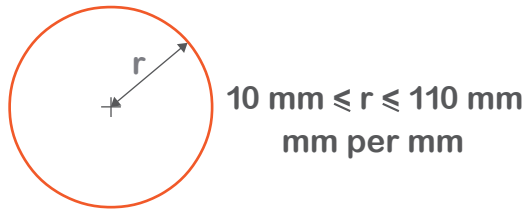

To draw two segments with an angle

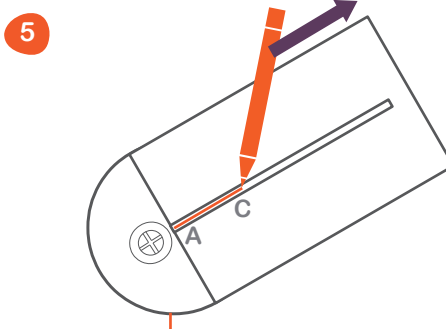
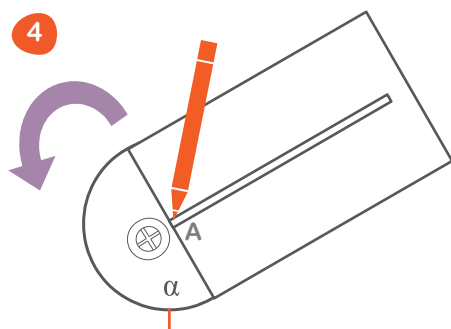
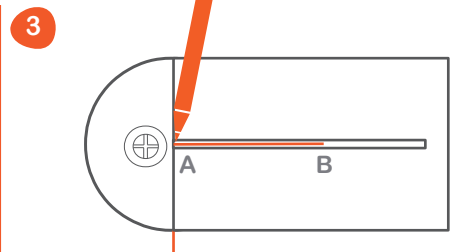
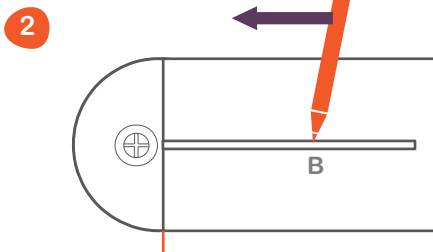
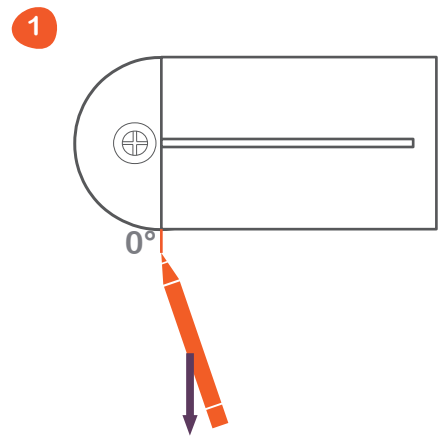

6 Result:

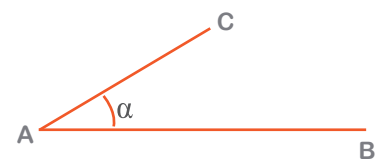

To draw a parallel

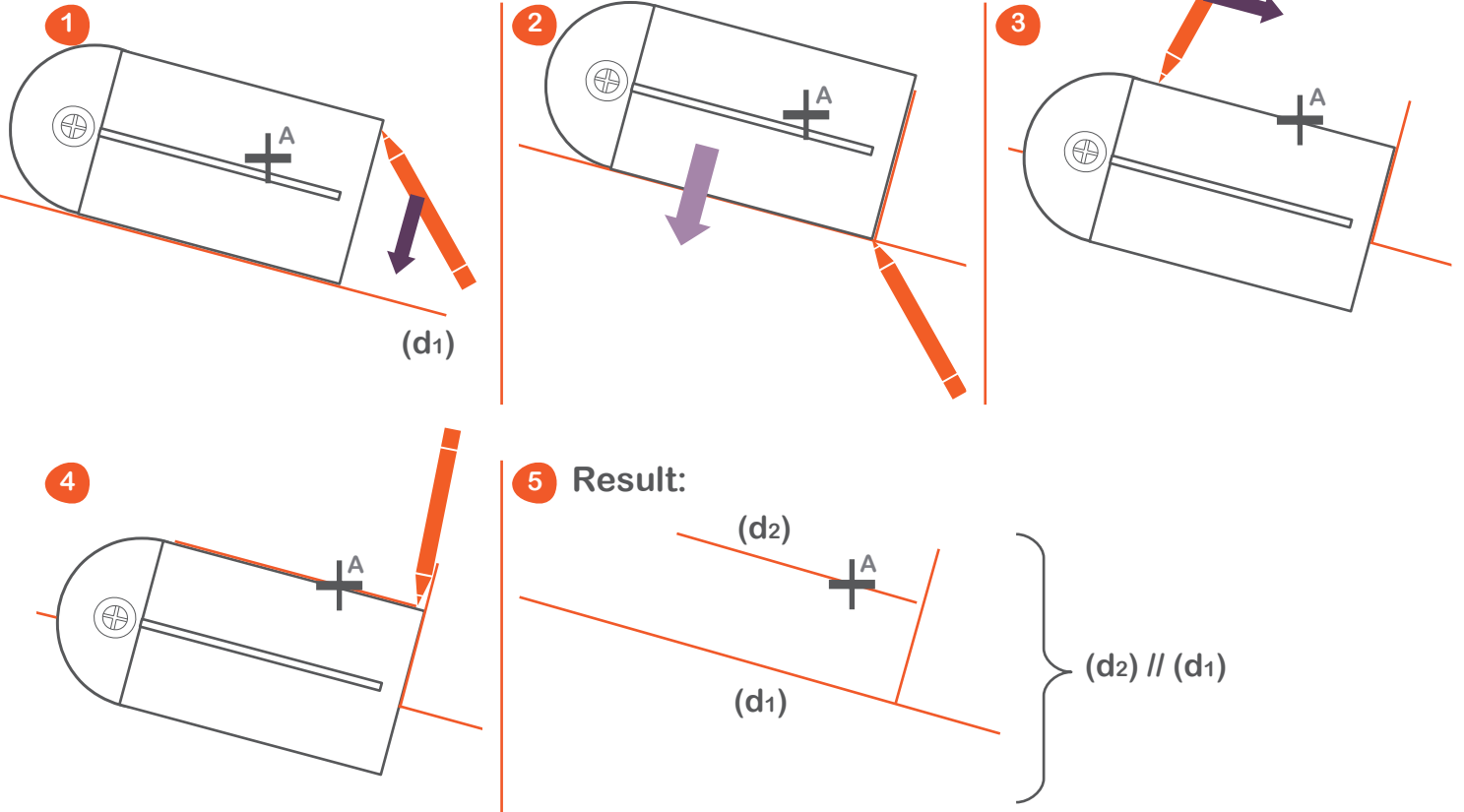

To draw a regular polygon

Principle:

Beginning

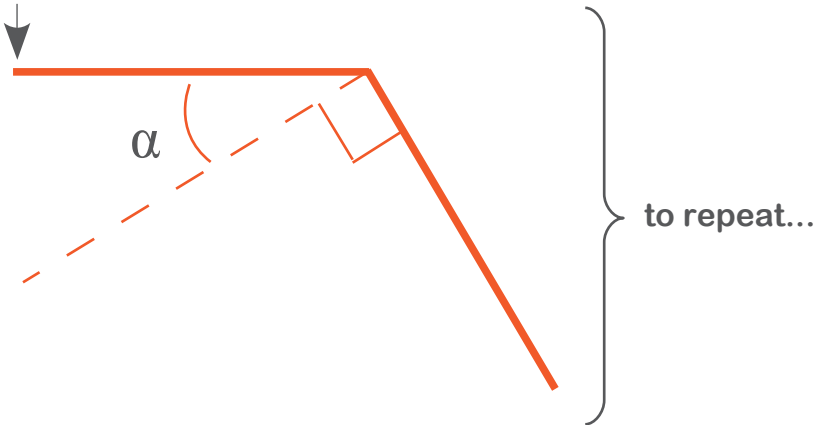

Choice of the angle α : (n = number of sides)

Type	n	α°
Square	4	0
Pentagon	5	18
Hexagon	6	30
Heptagon	7	38,5
Octagon	8	45
Enneagon or Nonagon	9	50
Decagon	10	54
Hendecagon	11	57
Dodecagon	12	60
Polygon with n sides	n	$90 - (360/n)$

Examples:

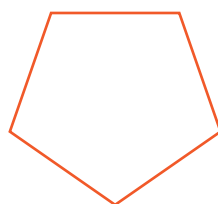

n = 5



n = 6

To draw a regular polygon With a thaMograph®

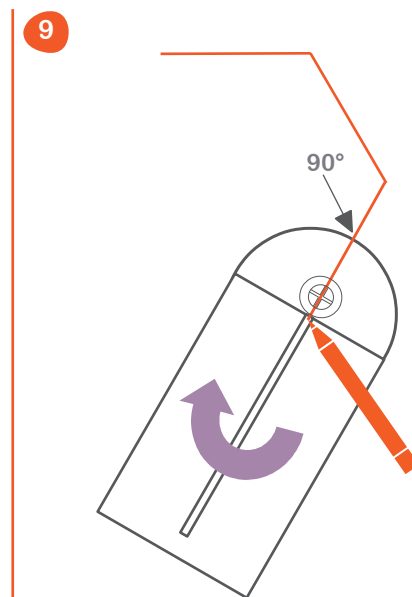
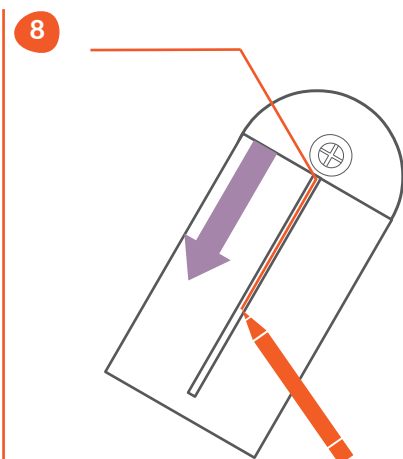
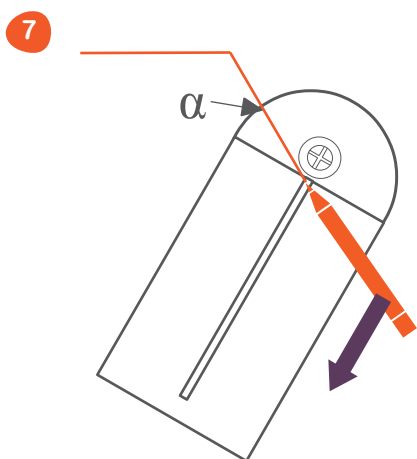
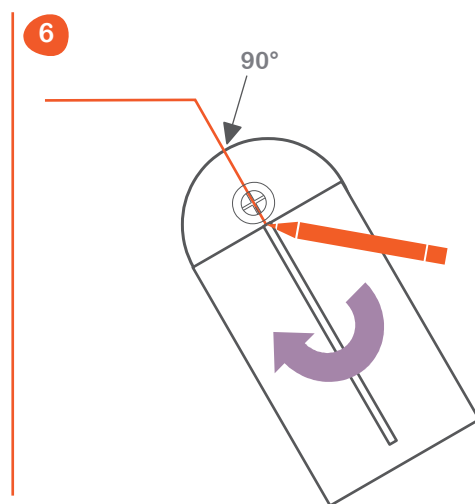
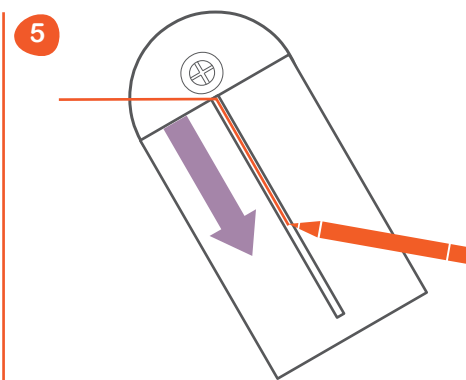
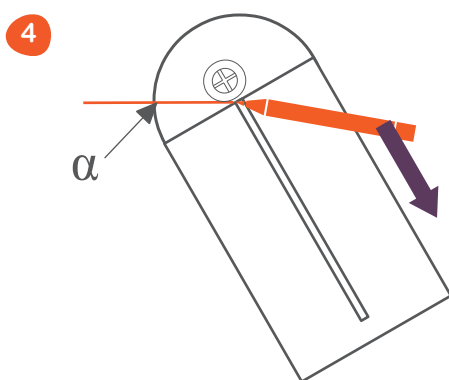
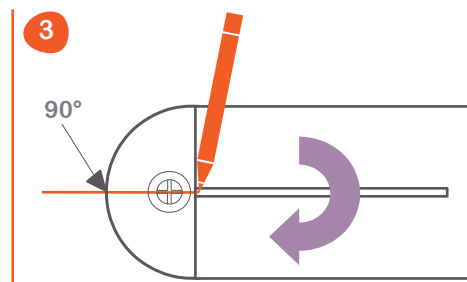
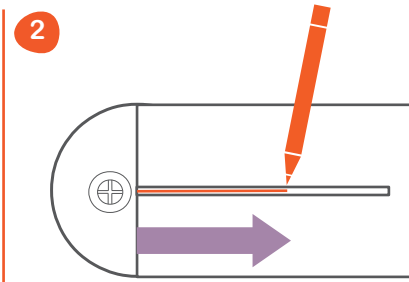
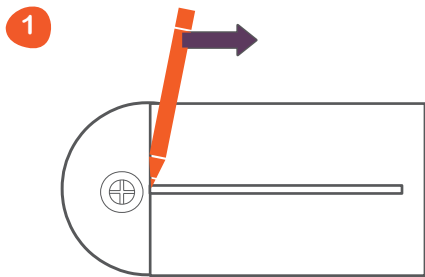

and so on...



For more details,
scan this flashcode.